

Michael Edge formerly Mathias Baum.  
N 70 E 226.3

John Walkey  
207<sup>a</sup> & allow.

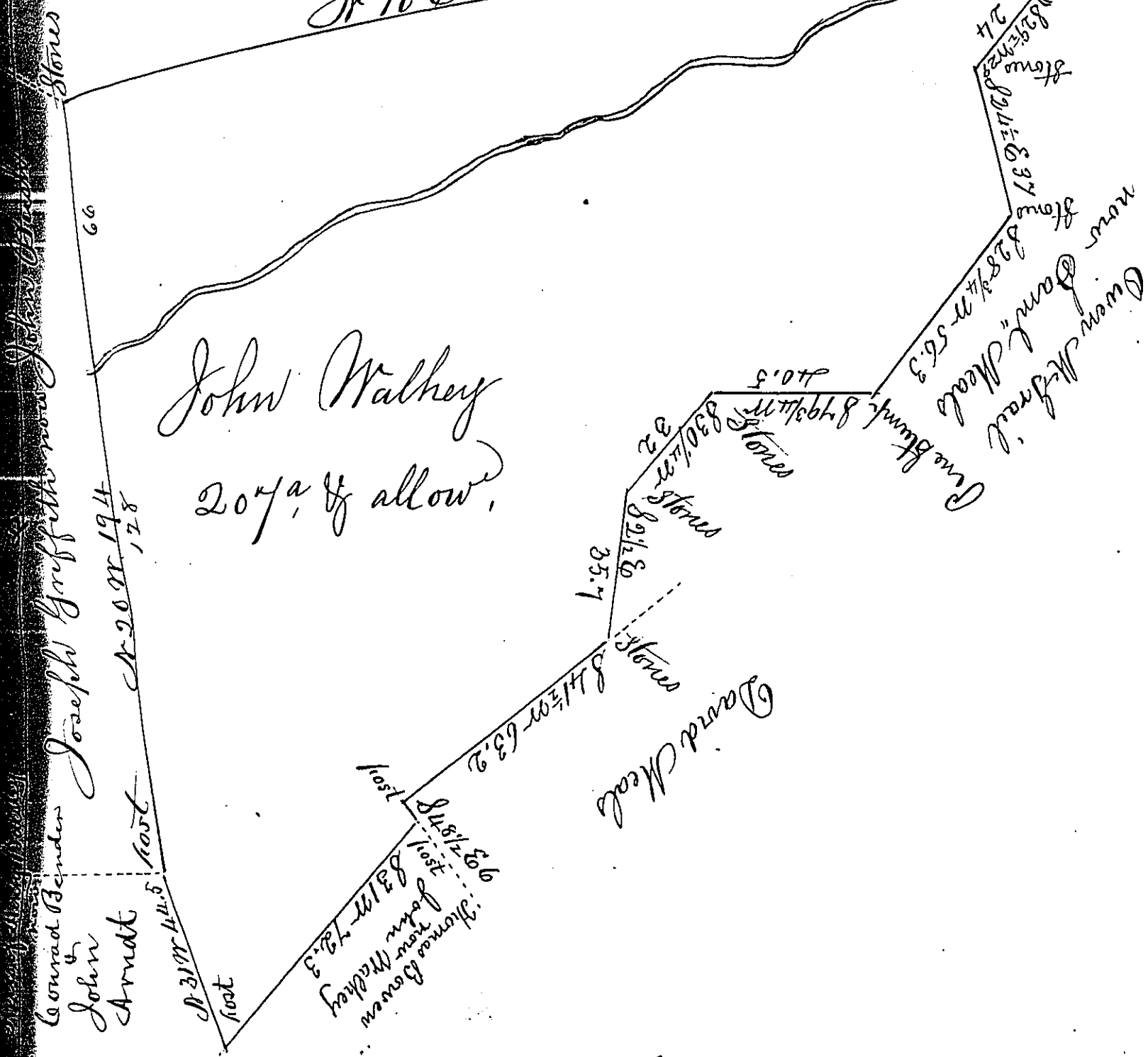

Situate in Mariellen Township Adams County, Surveyed April 10<sup>th</sup> 1812 in pursuance of a warrant granted to John Walkey for 220<sup>d</sup> dated August 1<sup>st</sup> 1811. Containing two hundred & seven acres & alls, on which there is at present no house, but was, a number of years ago, the tract must have been settled many years ago, probably before the revolution. It appears from the rights of 3 of the adjoining tracts that they were improved about the year 1765, and I am informed that there was large apple trees on it which the owner cut down, as the land has been held by different persons, there must be a chain of title papers but he would not show them to me. To Andrew Porter Esq. Surveyor Genl. Saml. Sloan D.S.

IN TESTIMONY that the above is a copy of the original remaining on file in the Department of Internal Affairs of Pennsylvania, made conformably to an Act of Assembly approved the 16th day of February, 1833, I have hereunto set my Hand and caused the Seal of said Department to be affixed at Harrisburg, this

Twelfth day of February 1834,  
*J. Simpson Africa,*  
 Secretary of Internal Affairs